



WCR
SPACE



BOWMAN HOUSE



**SMALL
OFFICE SUITES
TO LET**

2 Bridge Street, Reading RG1 2LU

Newly refurbished offices with air conditioning

Available on Flex-space Licences –
suites from 3 desks to 25+ desks

- Various suites, from 3 to 25+ desks
- Access to communal kitchen and courtyard
- Flexible easy in/out terms
- Purpose built offices behind a period façade
- Newly refurbished
- Prominent highly visible town centre location
- Access to secure rear courtyard with new communal seating area



Not sure if you want to repeat the door shot used above in the hexes so removed it from here.

BOWMAN HOUSE

2 Bridge Street, Reading RG1 2LU

Location

Bowman House is situated at the junction of Castle Street and Bridge Street, in central Reading close to the Oracle Shopping Centre, with easy access to the town's main facilities and railway station.

Description

Various newly refurbished air-conditioned office suites are available, each providing modern space in a building full of character. Access is provided to communal kitchens plus the courtyard, where external seating is provided in a landscaped environment.

Terms

New flexible Licences are available, allowing speedy occupation and savings on legal fees, further details upon application.

Available space

- **Ground Floor** – 1,850 sq ft – under offer.
- **First Floor** – Various smaller suites available, from 3 to 10 desks
- **Second Floor** – Space for 25+ desks available

The following suites will be available from November 2024, when the refurbishment is scheduled to be completed.

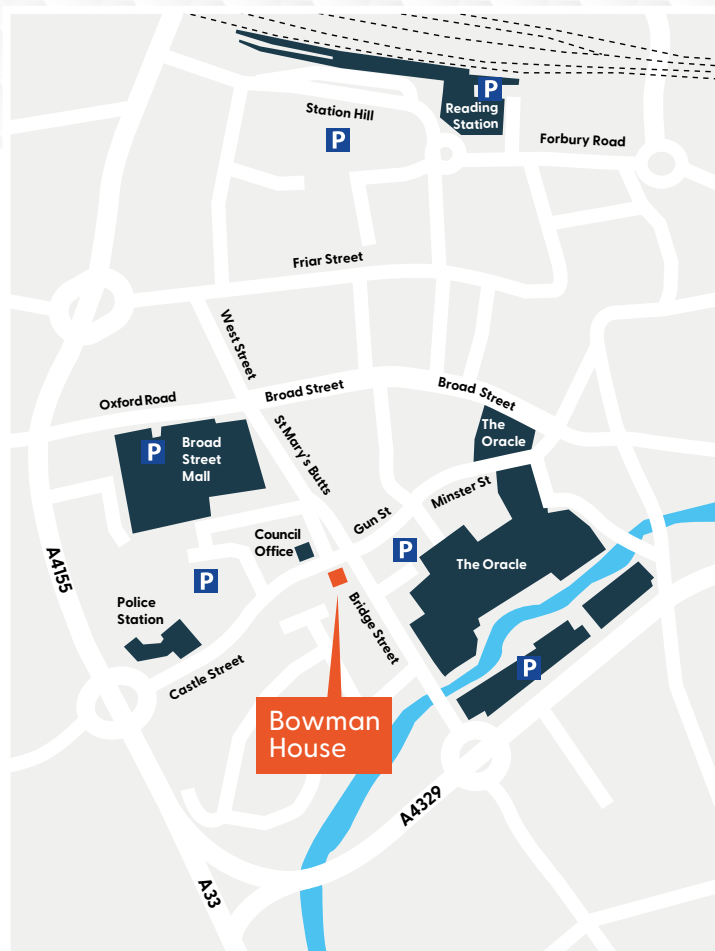

BOWMAN HOUSE

2/10 Bridge Street, Reading RG1 2LU

First Floor Suites available

Suite 1 – 6 desks

Suite 4 – 10 desks

Suite 2 – 8 desks

Suite 5 – 10 desks

Suite 3 – 3 desks

NB. Suite 1 can be split to provide a 3 desk and separate 6 desk suite. Suites 2 and 3 can be combined to provide a general office and meeting room or manager's office

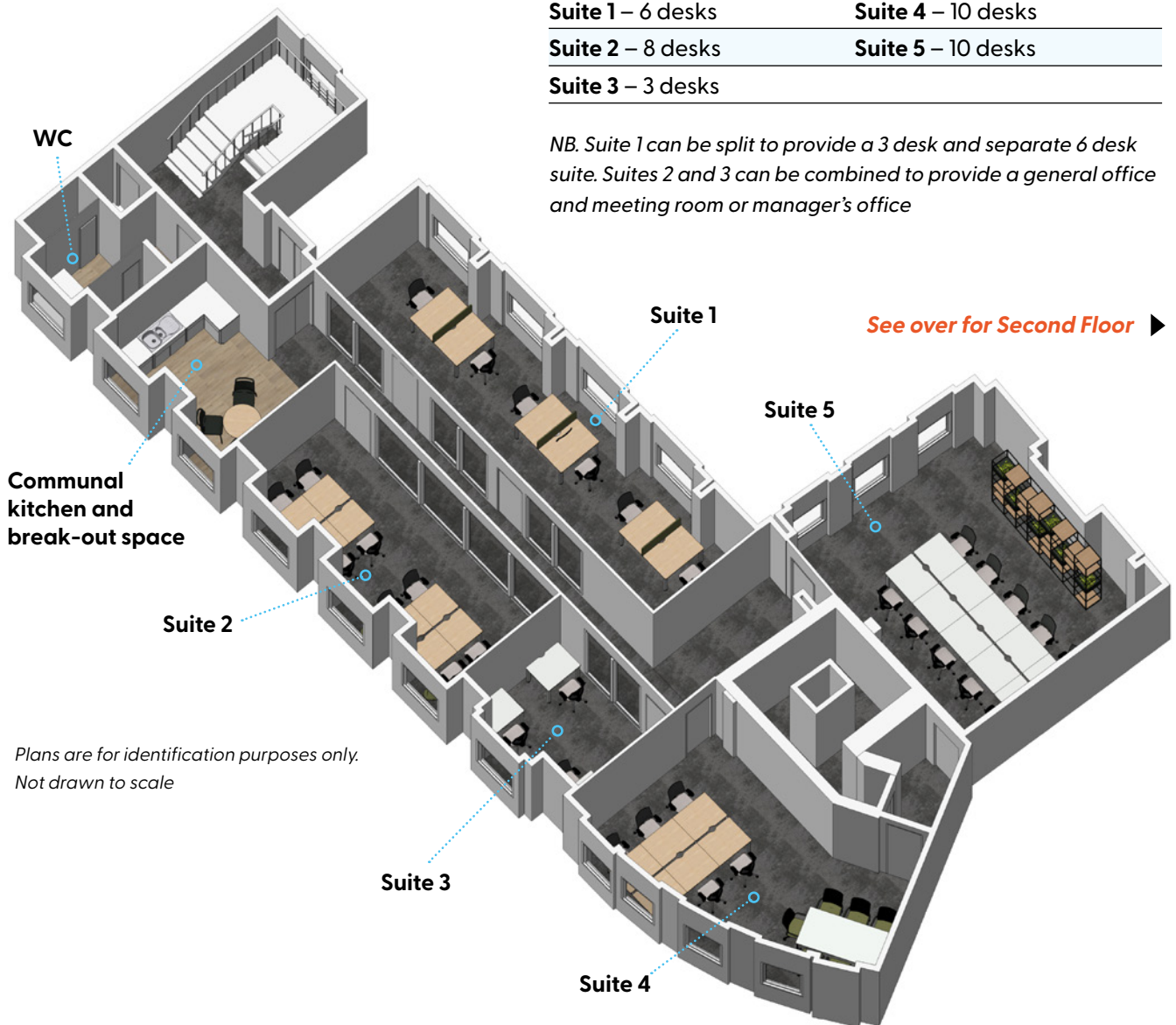

*Plans are for identification purposes only.
Not drawn to scale*



For further information or to arrange a viewing, please contact:

Mike Wallace

e: MWallace@wcr-space.co.uk

m: +44 (0)7718 661626

t: +44 (0)29 2088 3121

w: wcr-space.co.uk

Misrepresentation Act: WCR Space give notice that (i) The particulars are set out as a general outline only for the intended guidance of intended purchasers or lessees, and do not constitute any part of an offer or contract; (ii) All descriptions, dimensions, reference to condition and necessary permissions for use and occupation, and other details are given without responsibility and any intending purchasers or tenants should not rely on them as statements or representations of fact but must satisfy themselves by inspection or otherwise as to the correctness of each of them; (iii) No person in the employment of WCR Space has any authority to make any representation or warranty whatever in relation to this property. Contains CGI and computer enhanced photography. July 2024

BOWMAN HOUSE

2/10 Bridge Street, Reading RG1 2LU

Second Floor Suites available

Suite 7 – 12 desks

Suite 8 – 15 desks



*Plans are for identification purposes only.
Not drawn to scale*



For further information or to arrange a viewing, please contact:

Mike Wallace

e: MWallace@wcr-space.co.uk

m: +44 (0)7718 661626

t: +44 (0)29 2088 3121

w: wcr-space.co.uk

Misrepresentation Act: WCR Space give notice that (i) The particulars are set out as a general outline only for the intended guidance of intended purchasers or lessees, and do not constitute any part of an offer or contract; (ii) All descriptions, dimensions, reference to condition and necessary permissions for use and occupation, and other details are given without responsibility and any intending purchasers or tenants should not rely on them as statements or representations of fact but must satisfy themselves by inspection or otherwise as to the correctness of each of them; (iii) No person in the employment of WCR Space has any authority to make any representation or warranty whatever in relation to this property. Contains CGI and computer enhanced photography. July 2024